

INSTALLATION INSTRUCTIONS

120V Flexible LED Tape Electrical Hook Up and Channel Mounting

BEFORE YOU START:

- Please check local Electrical codes before beginning
- Turn power off before installing
- Make sure to use properly rated wire

NOTE: WE RECOMMEND THAT YOU ENGAGE A QUALIFIED AND LICENSED ELECTRICIAN. MODIFYING OR DISASSEMBLING BEYOND INSTRUCTIONS WILL VOID THE WARRANTY FOR THIS PRODUCT.

1. DETERMINE YOUR LAYOUT AND PLACEMENT OF LED TAPE. CLEAN SURFACE WHERE YOU ARE APPLYING TAPE TO MAKE SURE IT IS FREE OF DUST AND ANY MATERIAL THAT MAY IMPEDE ADHESIVE OR CLEAN INSTALLATION OF MOUNTING CHANNEL

2. POWER FEED: Vision120 can be either plugged into wall outlet, or hardwired into power feed. (FIG. 1). **MAKE SURE THAT ORIGINAL INLINE 8 AMP FUSE IS USED FOR BOTH PLUG-IN AND HARDWIRE OPTIONS. FAILURE TO NOT INSTALL FUSE PROPERLY VOIDS WARRANTY. FOR HARDWIRE APPLICATIONS, USE PROPER J-BOX BY OTHERS. CONNECT 120-PCHW TO LEADS COMING OUT OF JUNCTION BOX.**

3. INSTALLING 120 CHANNEL: When using screws, mark where mounting holes are to be drilled every twelve inches (FIG. 2) and install channel, screwing counter-sunk screws (by others) into mounting surface (FIG. 3). When using 3M tape apply it along entire length of channel.

INSTALLING TAPE WITHOUT MOUNTING CHANNEL: For tape installations indoors, where there is no moisture present, apply 3M double stick tape (sold separately) to entire length of LED tape and peel back to expose adhesive (FIG. 4). Firmly press tape into position.

NOTE: IF YOU ARE USING OTHER CHANNELS, I.E. LED-CHL-XD - USE 3M ADHESIVE BACK TO HOLD TAPE INTO THIS LARGER CHANNEL.

TAPE IS NOT FIELD CUTTABLE OR JOINABLE (FIG. 5). DO NOT EXCEED CORNERING TOLERANCES OF TAPE. TAPE CANNOT ROUND A CORNER TIGHTER THAN 2.5". FOR OUTDOOR MOUNTING, APPLY A BEAD OF WATERPROOF SILICONE AROUND BASE OF CHANNEL AND SEAL LENS TO CHANNEL WITH CAULK (FIG. 6).

4. ATTACHING LENS AND END CAPS Press lens down so that lens is captured inside rails of mounting channel. Attach end caps - one cap for end of run, the other cap for power connection end. Pry open tab for power connection end for power connector cable. This end cap hides the connector. (FIG. 7)

TOOLS NEEDED:

- Phillips screwdriver to attach mounting channel.

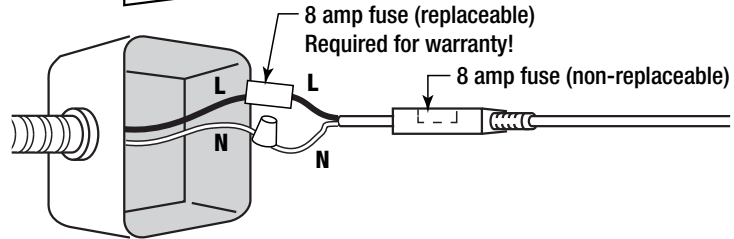
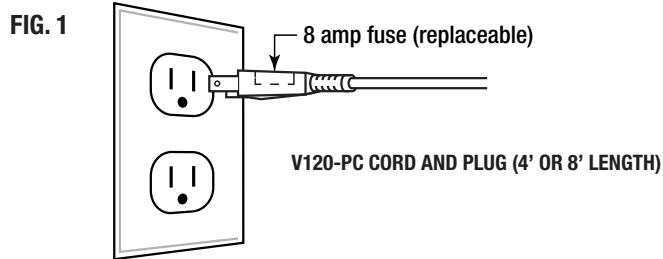

FIG. 2

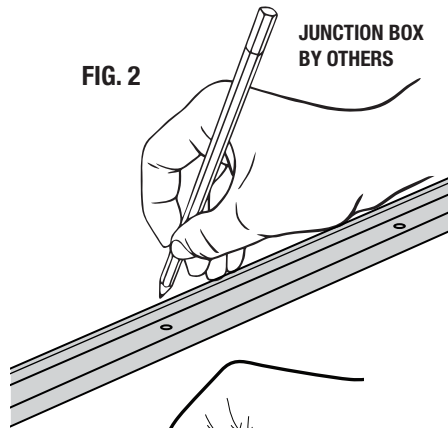

FIG. 3

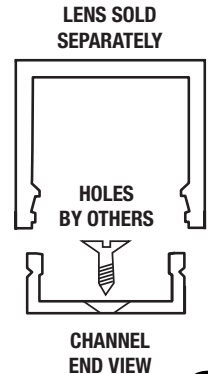

FIG. 4

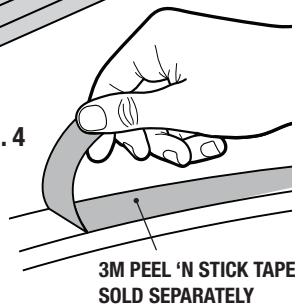
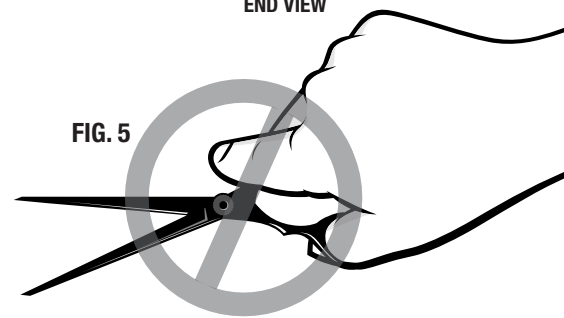
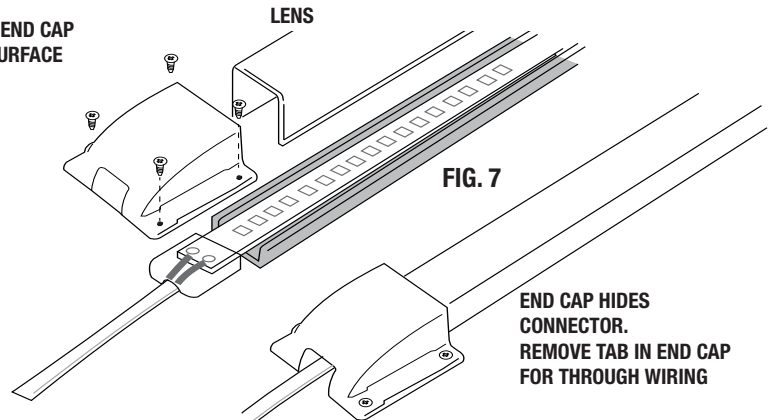

FIG. 5



SCREW END CAP ONTO SURFACE



FOR OUTDOORS INSTALLATION, ALSO SEAL LENS TO CHANNEL WITH CAULK

