

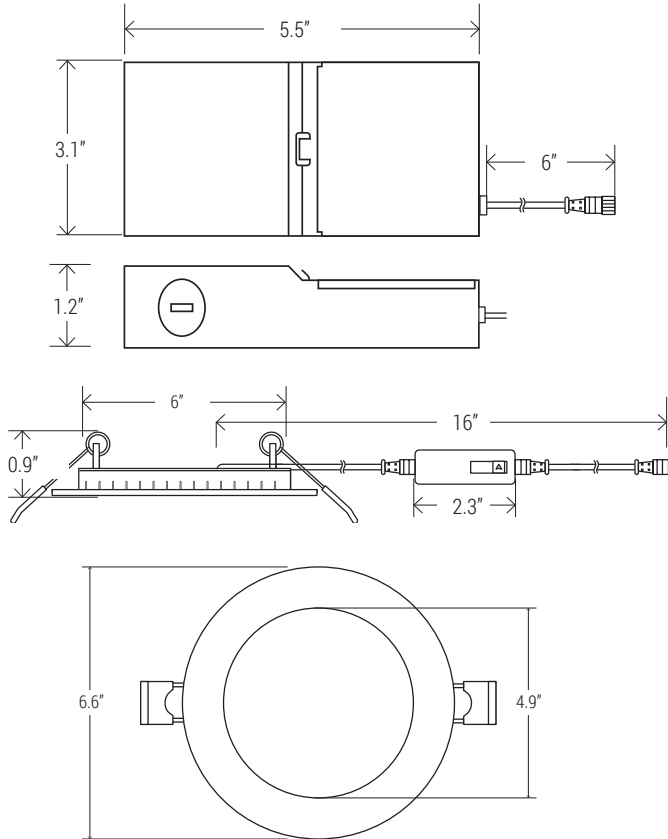

EASY 5 COLORS
SELECCTOR
2700K • 3000K • 3500K • 4000K • 5000K



| NOMINAL LUMENS | DELIVERED LUMENS | WATTAGE |
|----------------|------------------|---------|
| 700 | 847 | 12W |
| 1100 | 1235 | 14W |

Based on 4000K, 90+ CRI. Actual wattage may vary +/- 5%

INSTALLATION

Cut hole in ceiling. Insert luminaire into opening by squeezing spring clips on both sides of luminaire. The width in ceiling needed for the driver to fit is 3".

You **MUST** seal all gaps between the ceiling and fixture with weatherproof silicone sealant. This deters moisture and water from damaging fixtures and other mechanical ceiling elements.

FEATURES

6" round multi-CCT LED "Slim Disk" engineered for new construction, remodel, or retrofit to accommodate insulated or dropped ceilings. Easily access field-adjustable 5-Color SeleCCTOR switch by lowering the luminaire from the opening. Recessed housing not required, especially with limited plenum applications. Remote driver allows easy installation and maintenance. Small aperture and shallow depth are ideal for unlimited applications.

| | |
|-------------------|--|
| LUMENS | 700, 1100 |
| CCT | 27K/30K/35K/40K/50K |
| CRI | 90+ |
| COLOR QUALITY | 3-Step MacAdam Ellipse |
| CONSTRUCTION | Aluminum die-cast body and trim |
| TRIM OPTION | Round Flat Lens |
| TRIM COLORS | WH (White), BK (Black), BZ (Bronze), SN (Satin Nickel), CP (Copper), CH (Chrome) |
| DIMMING | DIMTR (Triac), DIM10 (0-10V) |
| EMERGENCY | 16W high voltage inverter (remote) |
| LIFETIME | L70 at 50,000 Hours |
| PHOTOMETRIC TESTS | In Accordance with IES LM79-08, LM80 and TM-30, TM-21 |

- IC-rated and Air-Tight ready and may be in direct contact with insulation.
- Can be installed in shallow plenum spaces.
- May be installed in drywall or suspended ceilings.
- Flicker-free 120V forward-phase dimming down to 5%.
- Even illumination achieved with patent-pending optics and edge-lit LED technology.
- Ideal where ceiling or top access is unavailable.



SLIM TRIM

TRIM RINGS

ACCESSORIES



RL675-RT-BK
(Black)



RL675-RT-BZ
(Bronze)



RL675-RT-CH
(Chrome)



RL675-RT-CP
(Copper)



RL675-RT-SN
(Satin Nickel)

RL675-RT-BZ



RL-ACC-SLIM-1-10F
10-ft long extension



RL-ACC-SLIM-1-20F
20-ft long extension



RL-UNV-4/5/6
For use with: 4", 5", 6"
Universal mounting plate

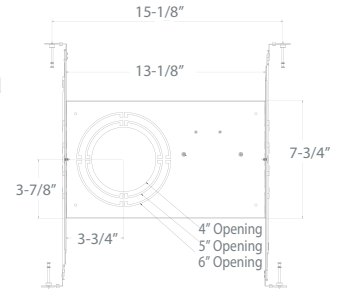

AL-ACC-SLIM-6-F-ROUGHPLATE
For use with: 6" downlights

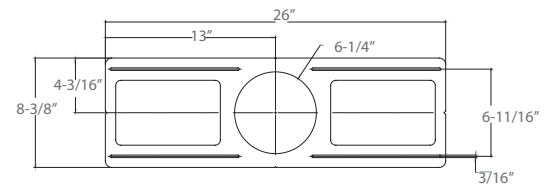
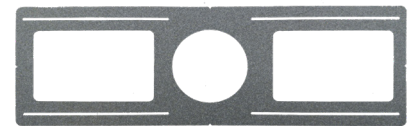
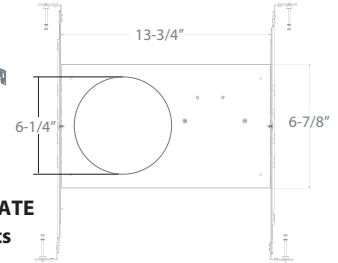

RL-ACC-SLIM-6-ROUGHPLATE
Rough-in plate for use with 6" downlights

RL-ACC-SLIM-1-10F

EXAMPLE:
RL675-700L-DIMTR-120-27K/30K/35K/40K/50K-90-WH

| TYPE | LUMEN | CCT | CRI | FINISH |
|-------|---|--|------------------------------|--|
| RL675 | <input type="checkbox"/> 700L-DIMTR-120 <input type="checkbox"/> 1100L-DIMTR-120 <input type="checkbox"/> 1100L-DIM10-120-347 | <input type="checkbox"/> 27K/30K/35K/40K/50K | <input type="checkbox"/> 90+ | <input type="checkbox"/> WH - White <input type="checkbox"/> BK - Black |

| ACCESSORIES |
|--|
| <input type="checkbox"/> RL675-RT-BZ - Bronze <input type="checkbox"/> RL675-RT-BK - Black <input type="checkbox"/> RL675-RT-CH - Chrome <input type="checkbox"/> RL675-RT-CP - Copper <input type="checkbox"/> RL675-RT-SN - Satin Nickel |

| OPTIONS |
|--|
| <input type="checkbox"/> RL-ACC-SLIM-1-10F - 10ft Long Extension <input type="checkbox"/> RL-ACC-SLIM-1-20F - 20ft Long Extension <input type="checkbox"/> RL-UNV-4/5/6 - Universal Mounting Plate for 4", 5" and 6" <input type="checkbox"/> RL-ACC-SLIM-6-ROUGHPLATE - 6" Mounting Plate <input type="checkbox"/> AL-ACC-SLIM-6-F-ROUGHPLATE - 6" Flanged Roughplate <input type="checkbox"/> EMG-LED-G-16W-HV-FLEX - 16W high voltage inverter (remote) |

RL675-700L-DIMTR-120-27K-30K-35K-40K-50K-90-WH

TEST NO.: **EL12191972**

INPUT WATTS: **11.5489**

LUMENS: **847**

CRI: **90**

EFFICACY: **73**

CCT: **4000K**

SPACING CRITERIA: **1.18**

Candle Power Distribution (Candelas)

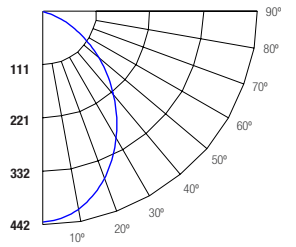

Zonal Lumens Summary

| Zone | Lumens | %Lamp | %Fixt |
|------|--------|-------|-------|
| 0-20 | 155.70 | 18.40 | 18.40 |
| 0-30 | 316.70 | 37.40 | 37.40 |
| 0-40 | 491.20 | 58.00 | 58.00 |
| 0-60 | 763.72 | 90.20 | 90.20 |
| 0-80 | 845.87 | 99.90 | 99.90 |
| 0-90 | 845.91 | 99.90 | 99.90 |

Luminance Data (cd/sq.m)

| Angle In Degrees | Average 0° | Average 45° | Average 90° |
|------------------|------------|-------------|-------------|
| 45° | 94050 | 94233 | 97574 |
| 55° | 72140 | 72749 | 76682 |
| 65° | 46168 | 47375 | 52226 |
| 75° | 12895 | 15196 | 21161 |
| 85° | 118 | 118 | 118 |

Lumens Per Zone

| Zone | Lumens |
|-------|--------|
| 0-10 | 41.42 |
| 10-20 | 114.27 |
| 20-30 | 161.00 |
| 30-40 | 174.50 |
| 40-50 | 156.62 |
| 50-60 | 115.90 |
| 60-70 | 64.68 |
| 70-80 | 17.47 |
| 80-90 | 0.04 |

Candela Tabulation

| 0 | 1 | 2 | 3 | 4 | 5 | 6 | 7 | 8 | 9 | 10 | | | | | | | | | | | |
|---|--------|---|--------|----|--------|----|--------|----|--------|----|--------|----|--------|----|-------|----|------|----|------|----|------|
| 0 | 442.00 | 5 | 436.50 | 15 | 402.04 | 25 | 343.89 | 35 | 271.40 | 45 | 194.28 | 55 | 120.88 | 65 | 57.00 | 75 | 9.75 | 85 | 0.03 | 90 | 0.03 |

Coefficients of Utilization - Zonal Cavity Method
Effective Floor Cavity Reflectance 0.20

| Cone of Light | | | |
|---------------|------|------|------|
| 2 | 111 | 3.7 | 3.7 |
| 4 | 27.6 | 7.4 | 7.4 |
| 6 | 12.3 | 11.1 | 11.1 |
| 8 | 6.91 | 14.8 | 14.7 |
| 10 | 4.42 | 18.4 | 18.4 |
| 12 | 3.07 | 22.1 | 22.1 |

(FT.) Distance to Plane (FC.) Initial Footcandle at Nadir (FT.) Beam Vert. Spread (FT.) Beam Horiz. Spread
BEAM DIA. MEASURED AT 50% OF NADIR F.C.

| ROOM CAVITY RATIO | RC | | 80% | | | | 70% | | | | 50% | | | | 30% | | | | 10% | | | | 0% | | | |
|-------------------|----|-----|-----|-----|-----|-----|-----|-----|-----|-----|-----|-----|-----|-----|-----|-----|-----|-----|-----|-----|-----|-----|----|--|--|--|
| | RW | 70% | 50% | 30% | 10% | 70% | 50% | 30% | 10% | 50% | 30% | 10% | 50% | 30% | 10% | 50% | 30% | 10% | 50% | 30% | 10% | 0% | | | | |
| 0 | 0 | 119 | 119 | 119 | 119 | 116 | 116 | 116 | 116 | 111 | 111 | 111 | 106 | 106 | 106 | 102 | 102 | 102 | 100 | 100 | 100 | 100 | | | | |
| 1 | 1 | 111 | 107 | 104 | 101 | 108 | 105 | 102 | 99 | 101 | 98 | 96 | 97 | 95 | 93 | 93 | 92 | 90 | 88 | 88 | 88 | 88 | | | | |
| 2 | 2 | 103 | 96 | 90 | 85 | 100 | 94 | 89 | 84 | 90 | 86 | 82 | 87 | 84 | 80 | 84 | 81 | 79 | 77 | 77 | 77 | 77 | | | | |
| 3 | 3 | 95 | 86 | 79 | 73 | 92 | 84 | 78 | 72 | 81 | 76 | 71 | 79 | 74 | 70 | 76 | 72 | 69 | 67 | 67 | 67 | 67 | | | | |
| 4 | 4 | 88 | 77 | 69 | 64 | 85 | 76 | 69 | 63 | 73 | 67 | 62 | 71 | 66 | 61 | 69 | 64 | 61 | 59 | 59 | 59 | 59 | | | | |
| 5 | 5 | 81 | 70 | 62 | 56 | 79 | 69 | 61 | 56 | 67 | 60 | 55 | 65 | 59 | 54 | 63 | 58 | 54 | 52 | 52 | 52 | 52 | | | | |
| 6 | 6 | 75 | 63 | 55 | 50 | 74 | 62 | 55 | 49 | 61 | 54 | 49 | 59 | 53 | 49 | 58 | 52 | 48 | 46 | 46 | 46 | 46 | | | | |
| 7 | 7 | 70 | 58 | 50 | 44 | 69 | 57 | 50 | 44 | 56 | 49 | 44 | 54 | 48 | 44 | 53 | 48 | 43 | 42 | 42 | 42 | 42 | | | | |
| 8 | 8 | 66 | 53 | 45 | 40 | 64 | 53 | 45 | 40 | 51 | 45 | 40 | 50 | 44 | 40 | 49 | 43 | 39 | 38 | 38 | 38 | 38 | | | | |
| 9 | 9 | 62 | 49 | 42 | 36 | 60 | 49 | 41 | 36 | 48 | 41 | 36 | 46 | 40 | 36 | 46 | 40 | 36 | 34 | 34 | 34 | 34 | | | | |
| 10 | 10 | 58 | 46 | 38 | 33 | 57 | 45 | 38 | 33 | 44 | 38 | 33 | 43 | 37 | 33 | 42 | 37 | 33 | 31 | 31 | 31 | 31 | | | | |

RC - Ceiling Cavity Reflectance RW - Wall Reflectance

RL675-1100L-DIMTR-120-27K-30K-35K-40K-50K-90-WH

TEST NO.: **EL11121926**

INPUT WATTS: **14.8497**

LUMENS: **1235**

CRI: **90**

EFFICACY: **83**

CCT: **4000K**

SPACING CRITERIA: **1.20**

Candle Power Distribution (Candelas)

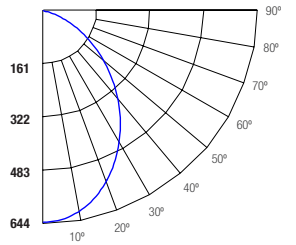

Zonal Lumens Summary

| Zone | Lumens | %Lamp | %Fixt |
|------|---------|-------|-------|
| 0-20 | 226.95 | 18.40 | 18.40 |
| 0-30 | 462.15 | 37.40 | 37.40 |
| 0-40 | 717.60 | 58.10 | 58.10 |
| 0-60 | 1116.75 | 90.40 | 90.40 |
| 0-80 | 1233.88 | 99.90 | 99.90 |
| 0-90 | 1233.92 | 99.90 | 99.90 |

Luminance Data (cd/sq.m)

| Angle In Degrees | Average 0° | Average 45° | Average 90° |
|------------------|------------|-------------|-------------|
| 45° | 141466 | 143006 | 146482 |
| 55° | 108819 | 111284 | 116034 |
| 65° | 69859 | 73415 | 79514 |
| 75° | 20619 | 24415 | 33712 |
| 85° | 157 | 118 | 118 |

Lumens Per Zone

| Zone | Lumens |
|-------|--------|
| 0-10 | 60.34 |
| 10-20 | 166.61 |
| 20-30 | 235.20 |
| 30-40 | 255.45 |
| 40-50 | 229.73 |
| 50-60 | 169.42 |
| 60-70 | 93.10 |
| 70-80 | 24.03 |
| 80-90 | 0.04 |

Candela Tabulation

| 0 | 1 | 2 | 3 | 4 | 5 | 6 | 7 | 8 | 9 | 10 | | | | | | | | | | | |
|---|--------|---|--------|----|--------|----|--------|----|--------|----|--------|----|--------|----|-------|----|-------|----|------|----|------|
| 0 | 643.02 | 5 | 637.26 | 15 | 590.83 | 25 | 508.93 | 35 | 404.97 | 45 | 292.23 | 55 | 182.34 | 65 | 86.25 | 75 | 15.59 | 85 | 0.04 | 90 | 0.04 |

Coefficients of Utilization - Zonal Cavity Method
Effective Floor Cavity Reflectance 0.20

| Cone of Light | | | |
|---------------|------|------|------|
| 2 | 161 | 3.7 | 3.7 |
| 4 | 40.2 | 7.4 | 7.4 |
| 6 | 17.9 | 11.2 | 11.2 |
| 8 | 10 | 14.9 | 14.9 |
| 10 | 6.43 | 18.6 | 18.6 |
| 12 | 4.47 | 22.3 | 22.3 |

(FT.) Distance to Plane (FC.) Initial Footcandle at Nadir (FT.) Beam Vert. Spread (FT.) Beam Horiz. Spread
BEAM DIA. MEASURED AT 50% OF NADIR F.C.

| ROOM CAVITY RATIO | RC | | 80% | | | | 70% | | | | 50% | | | | 30% | | | | 10% | | | | 0% | | | |
|-------------------|----|-----|-----|-----|-----|-----|-----|-----|-----|-----|-----|-----|-----|-----|-----|-----|-----|-----|-----|-----|-----|-----|----|--|--|--|
| | RW | 70% | 50% | 30% | 10% | 70% | 50% | 30% | 10% | 50% | 30% | 10% | 50% | 30% | 10% | 50% | 30% | 10% | 50% | 30% | 10% | 0% | | | | |
| 0 | 0 | 119 | 119 | 119 | 119 | 116 | 116 | 116 | 116 | 111 | 111 | 111 | 106 | 106 | 106 | 102 | 102 | 102 | 100 | 100 | 100 | 100 | | | | |
| 1 | 1 | 111 | 107 | 104 | 101 | 108 | 105 | 102 | 99 | 101 | 98 | 96 | 97 | 95 | 93 | 93 | 92 | 90 | 88 | 88 | 88 | 88 | | | | |
| 2 | 2 | 103 | 96 | 90 | 85 | 100 | 94 | 89 | 84 | 91 | 86 | 82 | 87 | 84 | 81 | 84 | 81 | 79 | 77 | 77 | 77 | 77 | | | | |
| 3 | 3 | 95 | 86 | 79 | 73 | 92 | 84 | 78 | 73 | 81 | 76 | 71 | 79 | 74 | 70 | 76 | 72 | 69 | 67 | 67 | 67 | 67 | | | | |
| 4 | 4 | 88 | 77 | 69 | 64 | 85 | 76 | 69 | 63 | 73 | 67 | 62 | 71 | 66 | 62 | 69 | 65 | 61 | 59 | 59 | 59 | 59 | | | | |
| 5 | 5 | 81 | 70 | 62 | 56 | 79 | 69 | 61 | 56 | 67 | 60 | 55 | 65 | 59 | 54 | 63 | 58 | 54 | 52 | 52 | 52 | 52 | | | | |
| 6 | 6 | 75 | 63 | 55 | 50 | 74 | 63 | 55 | 49 | 61 | 54 | 49 | 59 | 53 | 49 | 58 | 52 | 48 | 46 | 46 | 46 | 46 | | | | |
| 7 | 7 | 70 | 58 | 50 | 44 | 69 | 57 | 50 | 44 | 56 | 49 | 44 | 54 | 48 | 44 | 53 | 48 | 43 | 42 | 42 | 42 | 42 | | | | |
| 8 | 8 | 66 | 53 | 46 | 40 | 64 | 53 | 45 | 40 | 51 | 45 | 40 | 50 | 44 | 40 | 49 | 44 | 39 | 38 | 38 | 38 | 38 | | | | |
| 9 | 9 | 62 | 49 | 42 | 37 | 60 | 49 | 41 | 36 | 48 | 41 | 36 | 47 | 40 | 36 | 46 | 40 | 36 | 34 | 34 | 34 | 34 | | | | |
| 10 | 10 | 58 | 46 | 38 | 33 | 57 | 45 | 38 | 33 | 44 | 38 | 33 | 43 | 37 | 33 | 42 | 37 | 33 | 31 | 31 | 31 | 31 | | | | |

RC - Ceiling Cavity Reflectance RW - Wall Reflectance